

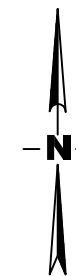

MUNICIPAL DISTRICT OF BIGHORN NO. 8
MUNICIPAL DEVELOPMENT PLAN

FIGURE 6
HARVIE HEIGHTS
FUTURE LAND USE MAP

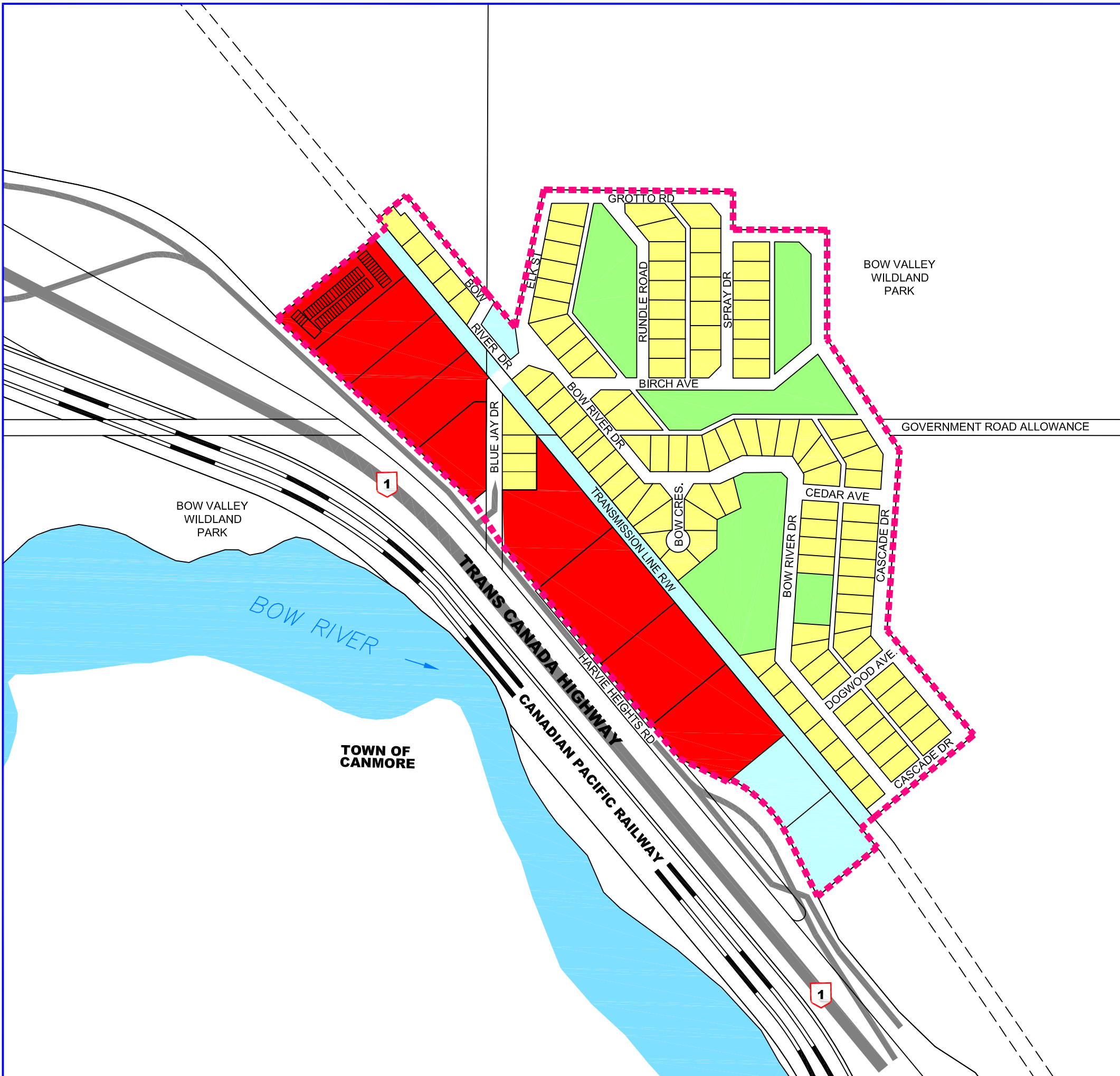

- PUBLIC UTILITIES
- COMMERCIAL
- RESIDENTIAL
- OPEN SPACES/ COMMUNITY RECREATION
- HAMLET BOUNDARY

REVISIONS

Note that these concepts are not the same as the land use designations established in the Land Use Bylaw. The Municipal Development Plan is only one in a series of planning documents.

COPYRIGHT: Municipal District of Bighorn No. 8. All rights reserved. Not to be copied in whole or in part. January 2013

BASE MAP PROVIDED BY ALTALIS
 The Municipal District of Bighorn No. 8 provides this information in good faith but provides no warranty nor accepts and liability arising from incorrect, incomplete or misleading information or its improper use.